

READ ME FIRST

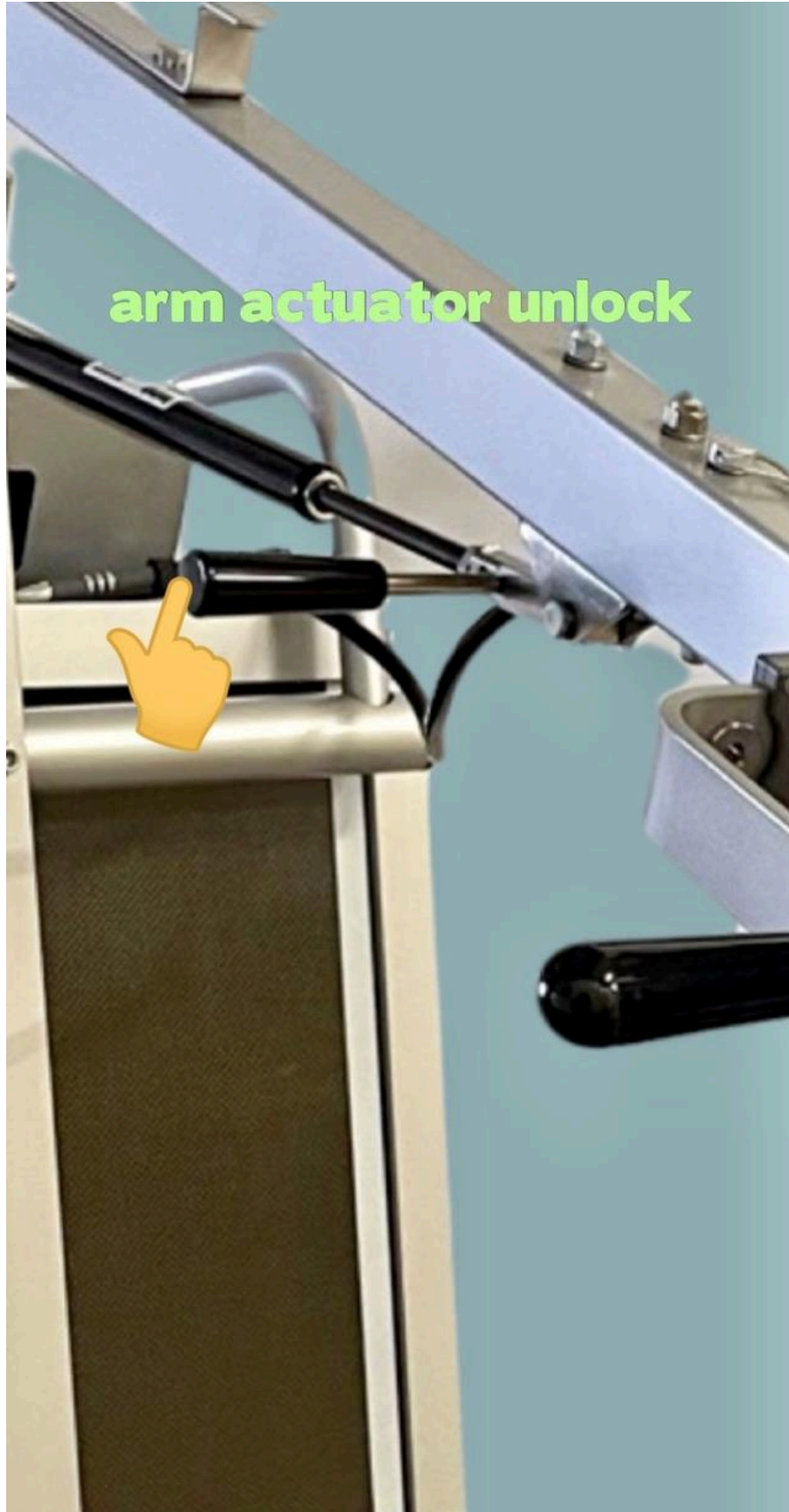



STAIR STEP STRAP SAFETY



RoadMaster Imaging Solutions
2024



**Do Not operate without
safety strap attached as
shown.**





**Transfer mode from
vehicle to facility.**

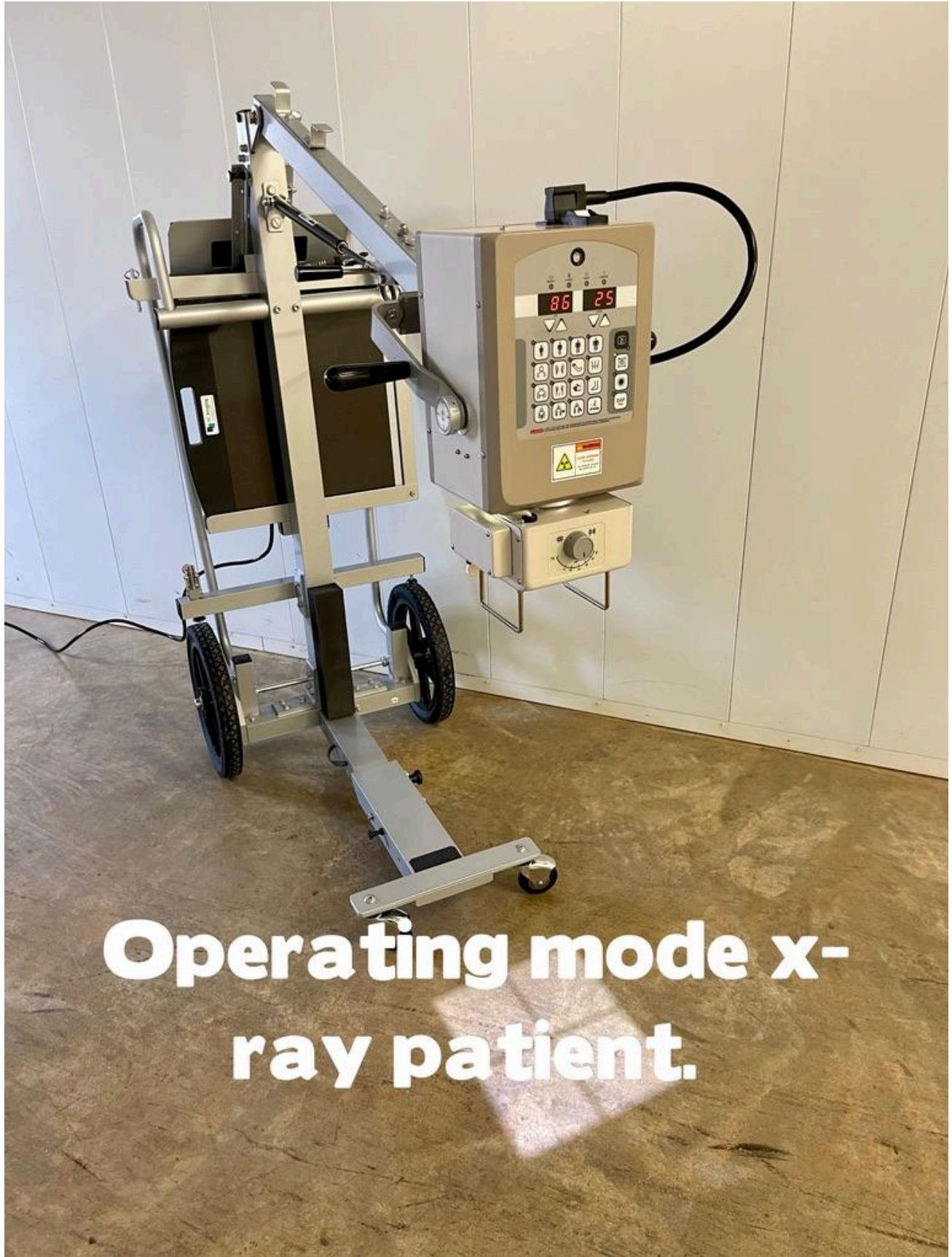

**Operating mode x-
ray patient.**



TRAVEL MODE



**Laptop Latch pull out and
move up or down.**

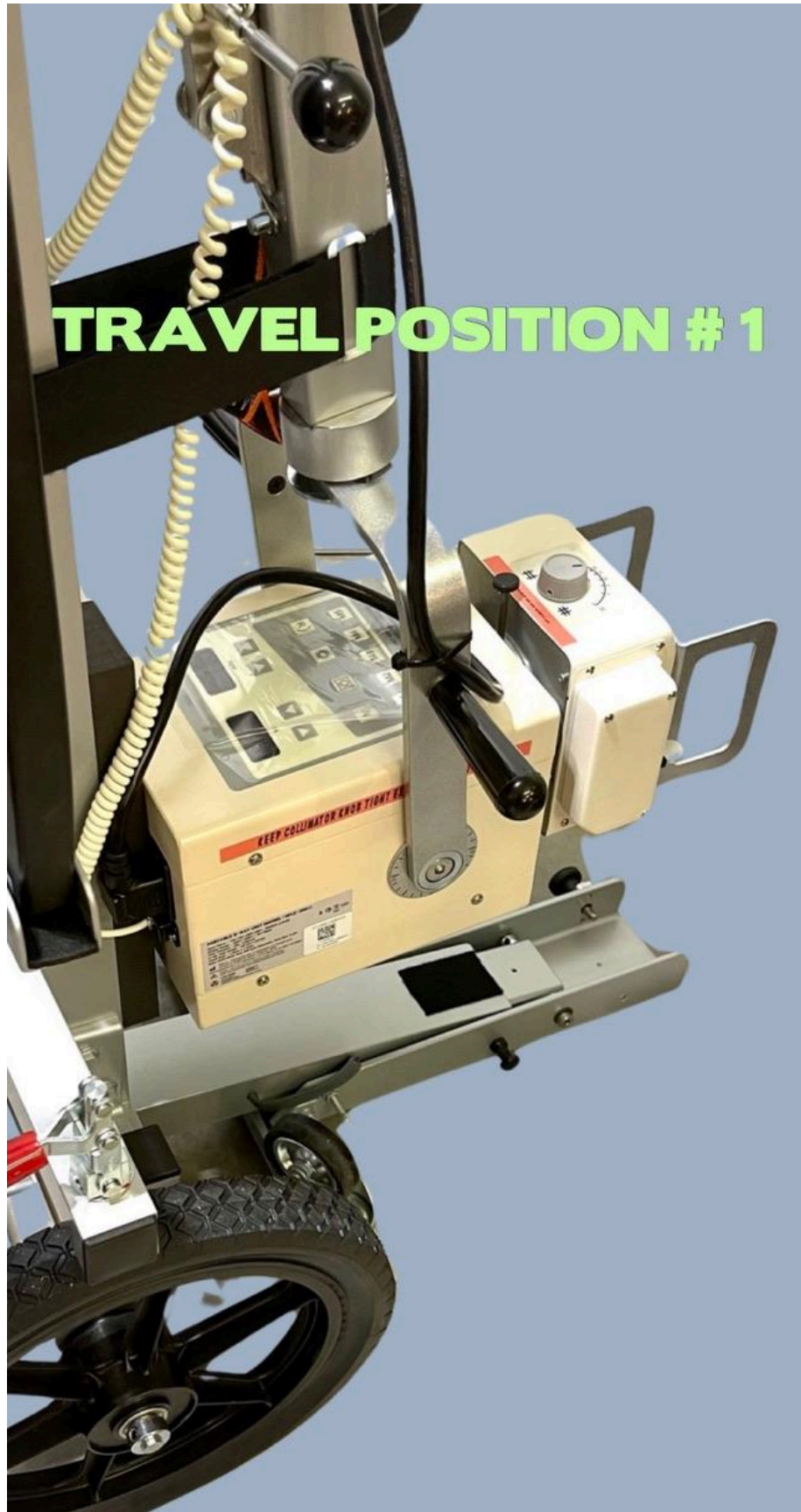

TRAVEL POSITION # 2





Lift pin only



**Foot Step
Area**

RoadMaster Imaging Solutions
2024

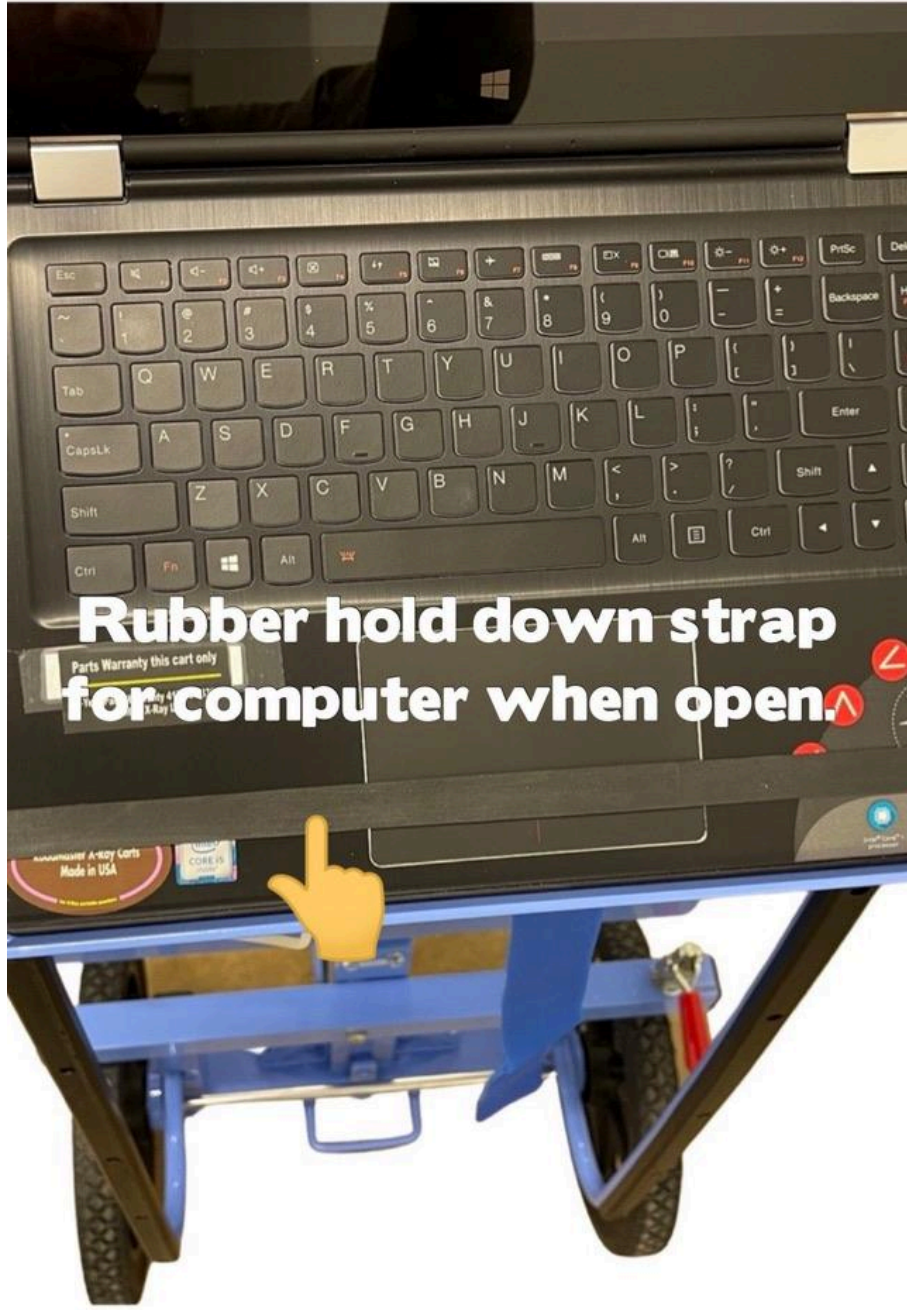

**Rubber hold down strap
for computer when open.**

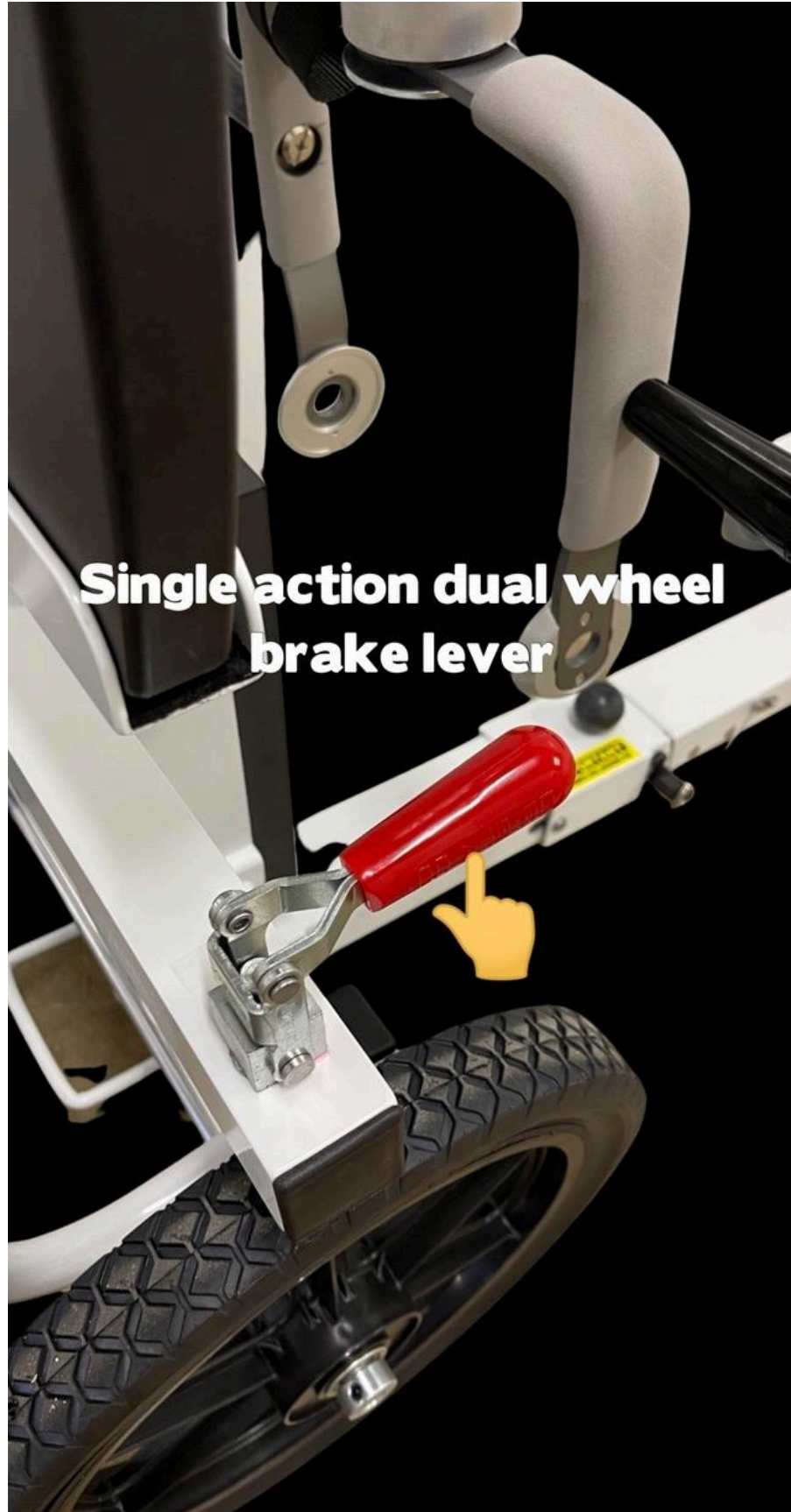

**Single action dual wheel
brake lever**

4Way Carts Only

Pages 16 - 19



Keep Un-Locked when moving Arm

Locked

Un-Locked

Lock if arm drifts ↗



ARM.



**Tube arm drift
Tension adjustment
Both sides**

RoadMaster X-Ray Cart One Year Limited Warranty

This warranty is provided by RoadMaster Imaging Systems, Inc. (Manufacturer) and applies to the RoadMaster X-Ray Carts (Product) purchased from an authorized dealer. The warranty is valid for a period of one year from the date of purchase.

Warranty Coverage:

1. Manufacturer warrants that the Product will be free of defects in materials and workmanship under normal use and service.
2. In the event of a defect covered under the warranty, Manufacturer will provide replacement parts at no additional cost, including shipping costs.
3. All warranty replacement parts will require the serial number of the RoadMaster cart that is under warranty.

Exclusions and Limitations:

1. This warranty does not cover any damage caused by misuse, negligence, accidents, unauthorized repairs, modifications or any other circumstances beyond Manufacturer's control.
2. Warranty does not cover normal wear and tear, cosmetic damages or damages resulting from improper maintenance or storage.
3. Warranty does not cover any costs associated with the installation or removal of the Product.
4. This warranty is non-transferable and applies only to the original purchaser.

Claims Procedure:

1. In the event of a defeat covered under this warranty, the purchaser must contact Manufacturer's Customer Service at (888) 212-7212
2. The purchaser must provide the original proof of purchase, including the date of purchase and the serial number of the RoadMaster Cart,
3. Manufacturer reserves the right to request additional information or documentation to validate the warranty claim.
4. Upon approval of the warranty claim, Manufacturer will provide replacement parts within a reasonable time frame.

General Provisions:

1. Manufacturer shall not be liable for any indirect, incidental or consequential damages arising out of or in connection with the Product or this warranty.
2. This warranty is the sole and exclusive warranty provided by Manufacturer and replaces all other warranties, whether expressed or implied, including any warranty of merchantability or fitness for a particular purpose.

For any inquiries or concerns regarding this warranty, please contact:

Phone: (888)212-7212
Email: info@myroadmaster.com
RoadMaster Imaging Solutions, Inc.
304 Market Street, Suite D
Rockwell, NC 28146

This warranty gives you specific legal rights and you may also have other rights, which vary from state to state.